

PLANTA BAIXA
Escala 1:100

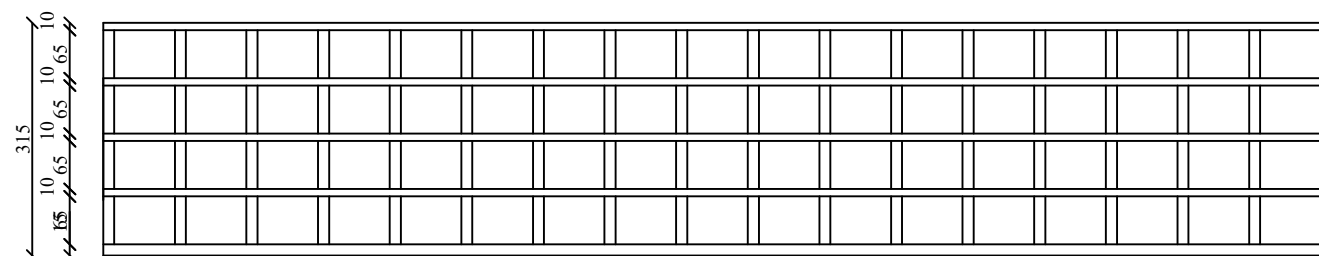

CORTE AB
Escala 1:100

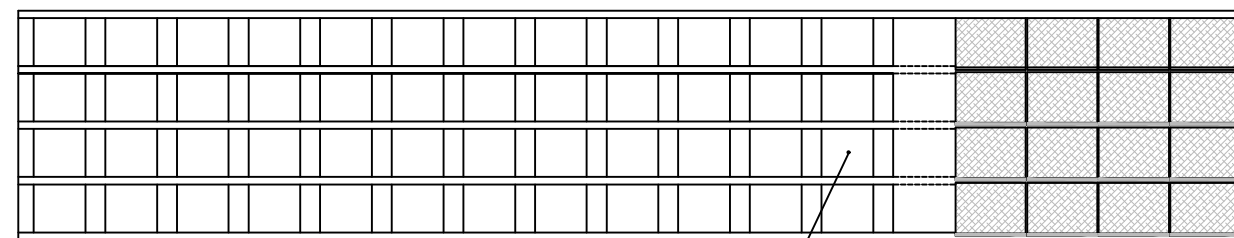

FACHADA
Escala 1:100

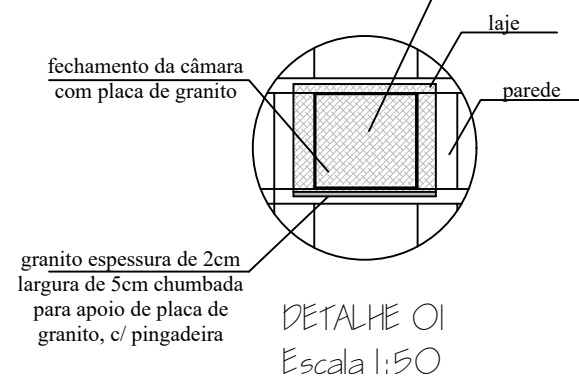

DETALHE 01
Escala 1:50

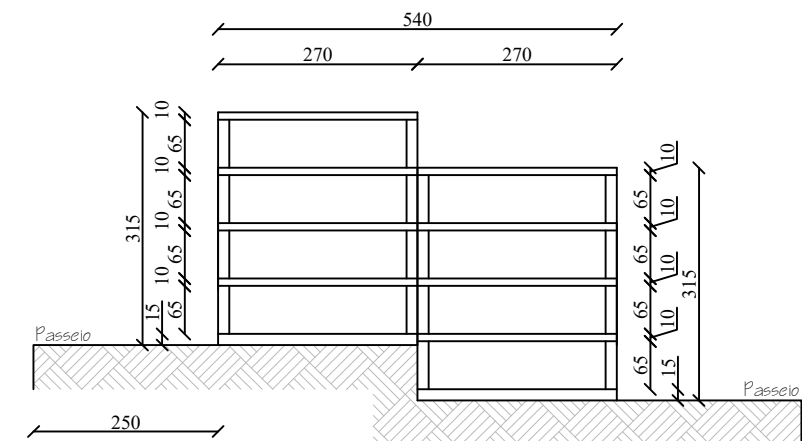

CORTE AA'
Escala 1:100



Ana Paula Rizzi Oliveira
Engenheira Civil - CREA MG 161.303
anapaularizzioliveira@gmail.com - TEL (32) 98417 6534

Projeto arquitetônico para construção de Cemitério Vertical -
Cemitério Municipal de Divino - MG

Proprietário:

Prefeitura Municipal de Divino
Mauri Ventura do Carmo

Resp. Tec.:

Ana Paula Rizzi Oliveira - CREA-MG 161.303/D

Escala:

Indicadas

Data:

Fevereiro / 2021

Prancha:

01/01